

Top Specifications:

Veneers: Architectural grade veneers. Standards (Walnut, Oak, Maple) Standard veneer layup:
(Walnut - Flat cut (plain sliced) book match), (Oak - Flat cut (plain sliced) book match),
(Maple - Flat cut (plain sliced) Slip match)

Core: All tops are fabricated with 1 1/8" thick Industrial grade particleboard 45lb. density or
Mdf (Medium Density Fiberboard)

Rustic Reclaimed Veneer - Walnut and Oak - Flat cut (plain sliced) Random match

Rustic Reclaimed Core: 1 1/2" thick particle board or Mdf

All tops over 120" are two sections. *Veneer* grain on multiple section tops is running short grain. (*Exception*) *Rustic Reclaimed Veneer* grain runs length wise is random matched unless other wise specified. *Laminate* woodgrain on multiple section tops is running length wise and is not matched up with grain on other section.

Laminate tops: are fabricated with 1 1/8" thick 45 lb. density particle board core. Laminates are standard colors from **Wilsonart and Formica.**

Laminates:

Standards:

1572-60 Antique White
1573-60 Frosty White
1595-60 Black
D315-60 Platinum Grey
D354-60 Designer White

D90-60 North Sea
D91-60 Slate Grey
D92-60 Dove Grey
D96-60 Shadow
4841-60 Desert Zephyr

Woodgrains:

7909-60 Fusion Maple
7937-38 River Cherry
7946-38 Brazilwood
7997-38 Ebony Recon
7054-60 Wild Cherry

7999k-12 Field Elm
8201k-12 Grey Elm

For all other patterns and laminates, contact factory for pricing and availability

Custom request (Size, Top, Color, etc.) Contact :

Cornerstone Furniture, www.cornerstonefurniture.com , ph. (269)795-3379

Edges: 3mm (3/16" thick solid hardwood) Flat eased or Reverse bevel.

Live Edges: 1 1/2" thick solid hardwoods, Core: 1 1/2" thick particle board or Mdf

Standard Wood Veneer Finishes:

Walnut: Clear Walnut, Natural Walnut, Warm Walnut, Dark Walnut.

Oak: Clear White Oak, Natural White Oak, Brown Oak, Pewter Oak, Charcoal Oak

Maple: Clear Maple, Fusion Maple

Wood is a natural material, slight variations will occur in color, grain configuration, and stain acceptance. Finished pieces may vary slightly in tone or character from the samples given, and no guarantee can be made of an exact match.

Semi-filled finish is standard. *Clear Coating :* *Satin* 40 degree sheen , *Flat* 10 degree sheen

Custom Finish matching is available for a **10% upcharge per order** (**\$500.00** minimum list.)

Bases: 2" tubular steel. Finishes: Powder coats: Black, Dark tone, Silver, Medium Gray, White.
Polished or Satin Chrome— add to list \$160 each base

Sample Order:

(Edge)	Model #.	Shape.	Dimensions.	Top.	Edge.	Finish.	List \$
(SV3FE)	CMRE48120	- Rectangular	48 x 120	-	White Oak veneer,	# SV3FE , - Pewter Oak -	\$5859

Modern Industrial Credenza Specs



Shown in:

Dimensions: 72"l x 20"w x 31"h

Top: Walnut veneer .75" thick

Edge: Flat eased

Bases: Metal rectangle mount

Finish: Walnut Natural #WNT

Custom sizes, woods and finishes are available.
Contact Cornerstone Furniture to discuss options.
Thank you.

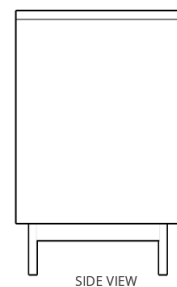
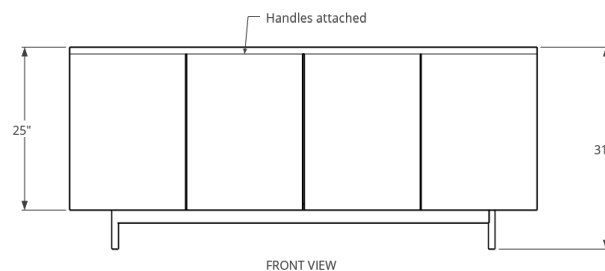
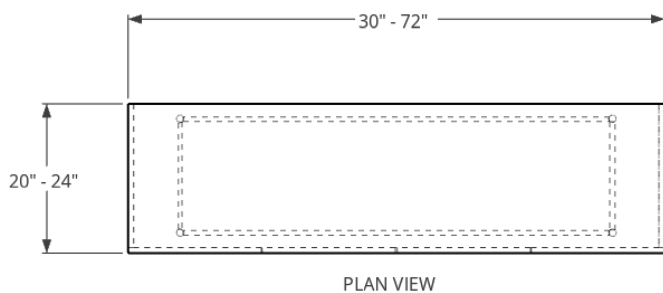

Specifications

Dimensions: 30" - 72" length x 20" & 24" Depth x 31" height.

Tops: Veneer, Designer Veneer, Laminate. Plain sliced, book or slipped matched, balance backer.

Edges: Flat eased

Bases: Metal rectangle mount

Finishes: Check out our finishes in the Price List or contact us for more information.

Handles: Handles are provided by Cornerstone Furniture



Modern Industrial Credenza

Dimensions W x D x H	Doors	Model #	Veneer	Laminate	Model #
			List Price \$	List Price \$	
60x20x29	3	CRV602029	5678.00	4655.00	CRL602029
72x20x29	4	CRV722029	6234.00	5238.00	CRL722029
60x20x36	3	CRV602036	6362.00	4959.00	CRL602036
72x20x36	4	CRV722036	7078.00	5789.00	CRL722036

Credenzas Options:	List Price \$
Gold legs	2289

Add 10% to Pricelist